

NOTES:

ALL THE DIMENSIONS IN THIS SHEET ARE IN FEET & INCHES
BASEMENT AT 15' FEET HEIGHT FROM FINISHED FLOOR LEVEL (FFL)

CEILING HEIGHT - 12'-0"
SLAB THICKNESS - 6"
PLINTH THICKNESS - 5"

SITE DIMENSIONS: 350'-0" X 390'-0"
SITE AREA: 1,29,000 SQ.FT.

LEGEND:

150 CAR CAN BE PARKED IN THE BASEMENT ACCORDING TO THE STANDARDS AND THE AREA GIVEN WHICH INCLUDES THREE ENTRY AND EXIT GATES FOR EASY CROWD DISTRIBUTION.

PLINTH LEVEL 3'-0"
GROUND FLOOR CEILING HEIGHT 12'-6" FROM (FFL) FINISHED FLOOR LEVEL
FIRST FLOOR CEILING HEIGHT 12'-0" FROM (FFL)
SECOND FLOOR CEILING HEIGHT 12'-6" FROM (FFL)

SCREEN -O1 OVERALL THEATRE HEIGHT FROM AFL 55'-0"
SCREEN-O1/O5 OVERALL THEATRE HEIGHT FROM AFL 30'-0"

BASEMENT HEIGHT FROM GROUND LEVEL 15'-15'-0"

ACOUSTIC SOLUTIONS PANEL BOARDS
RANGE FROM 6" FOR CEILING
10" FOR SIDE WALLS WHICH COVERS THE THEATRE

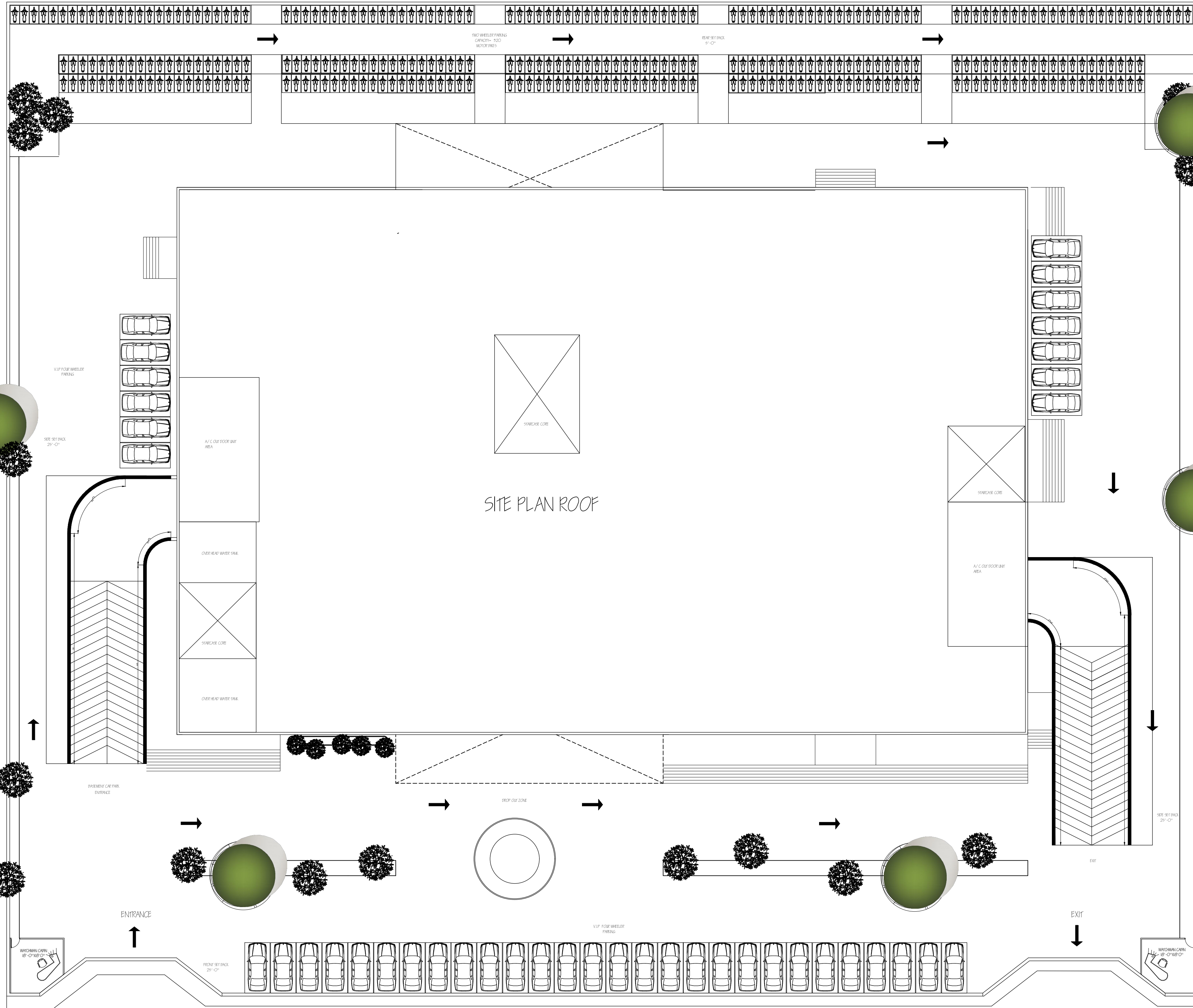

SITE PLAN ROOF

PROJECT NAME:

MULTIPLEX DESIGN

CLIENT NAME:

FLUX CINEMAS

DRAWING NAME:

SITE PLAN ROOF LAYOUT

NAME:

HUZefa KAPI

DATE:

21/03/19

SCALE:

1:250

SHEET NUMBER:

06